

ADAPT-MAT DESIGN PROCESS

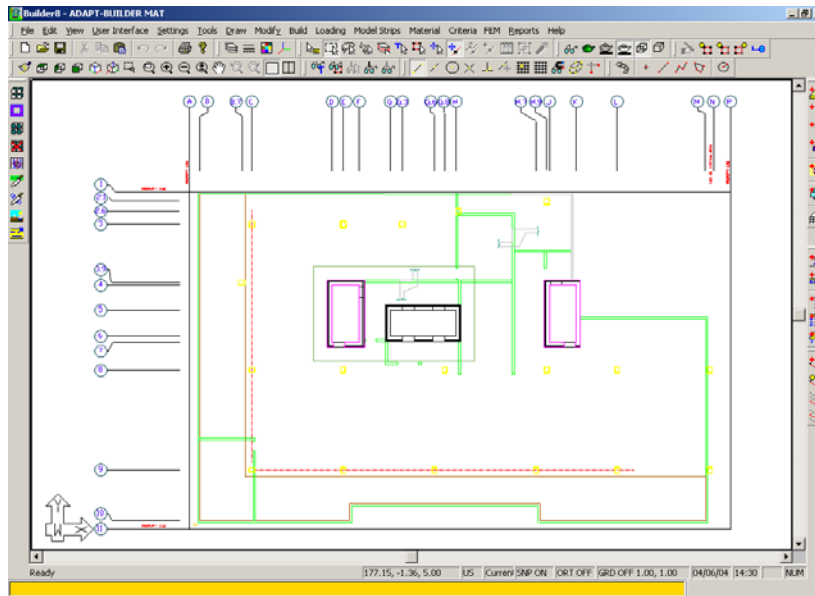

(a) *DWG* file is imported into *ADAPT-Modeler*.

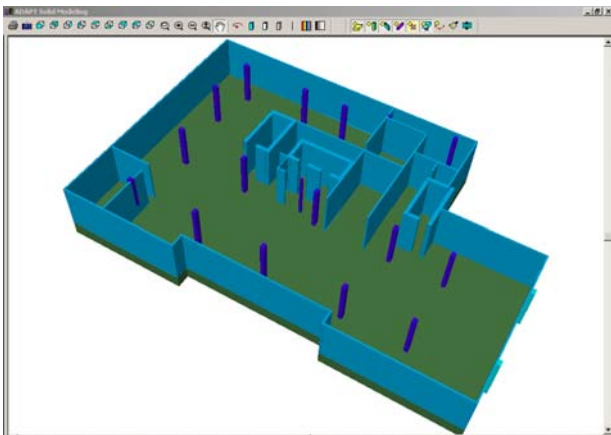

(b) Imported drawing is converted into *structural components*.

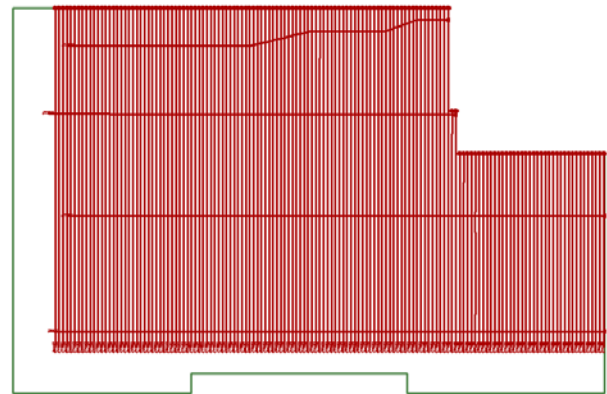

(c) Post-tensioning *tendons* are generated.

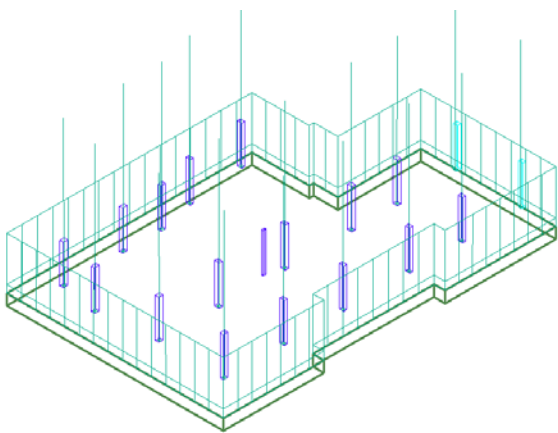

(d) *Loads* are applied on the structure and *load combinations* are created.

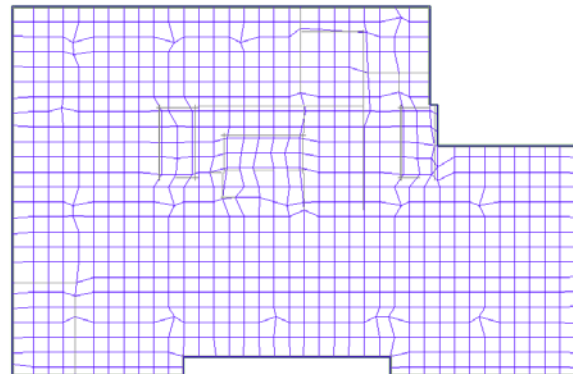

(e) *Finite Element mesh* is generated automatically in *ADAPT-Floor Pro*.

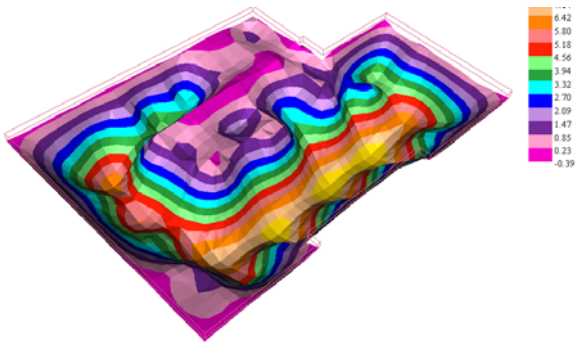

(f) **Deflected shape contour** from Finite Element Method (FEM) demonstrates behavior of structure.

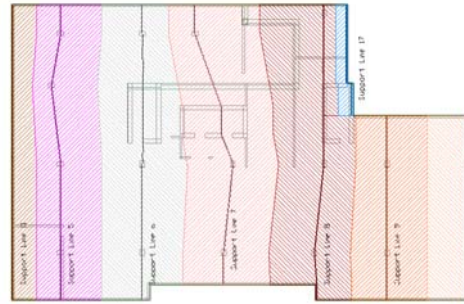

(g) **Design Strips** are created in two orthogonal directions.

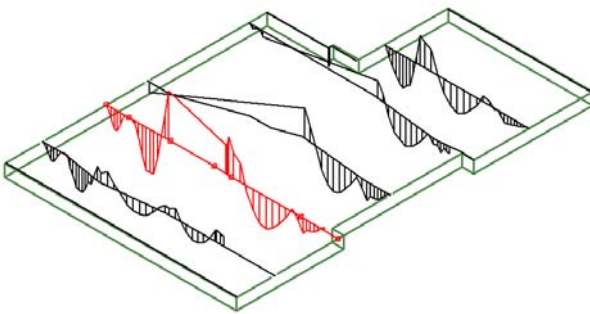

(h) Using FEM results, **design moments** are evaluated for each Design Strip.

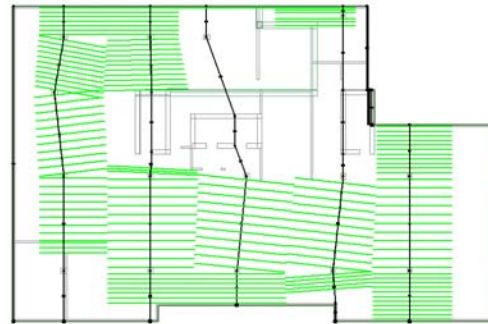

(i) **Design Sections** are generated automatically for **stress check**. Calculated stresses are compared with allowable values. Green lines indicate regions where values are within code limits.

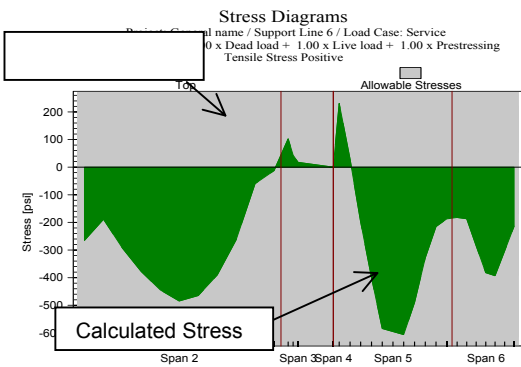

(j) **Calculated stresses** for each Design Strip are displayed against the background of the **allowable stress envelope**.

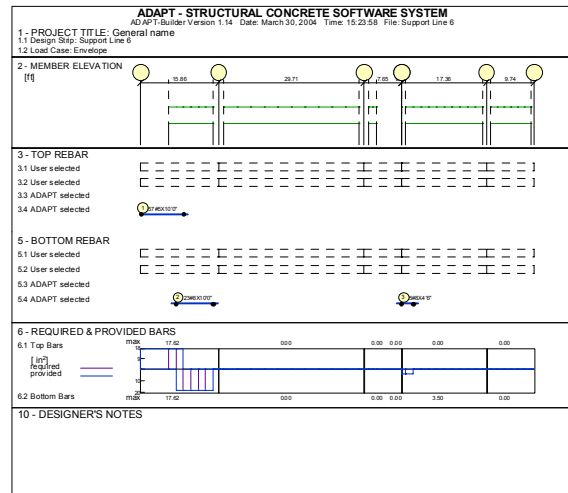

(k) **Reinforcement** for each design strip is automatically selected by the program and displayed, specifying the **location**, **number** and **length** of bars.